

SYM CUESTA

Brand New Item!

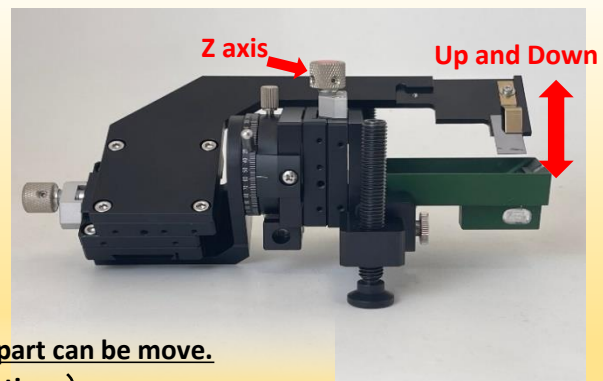

- ◆ Easy to pick up the serial section for SEM
- ◆ Two way of the collection Lift & Scoop Up)
- ◆ Outstanding sense of stability with SYM JUMBO

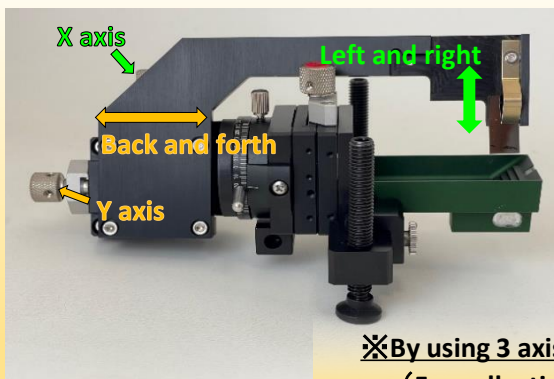

✕By using 3 axes, arm part can be move.
(For collecting the sections)

~Features of a Plate~

1. Fixable of glass slides and silicon wafers
2. Adjust the X,Y,Z axes at your own convenience
3. Easy to collect the sections by turnin axes (X or Z)
4. No stress and Very stable
5. Collect the serial sections easily by this routine work

How to use SYM CUESTA

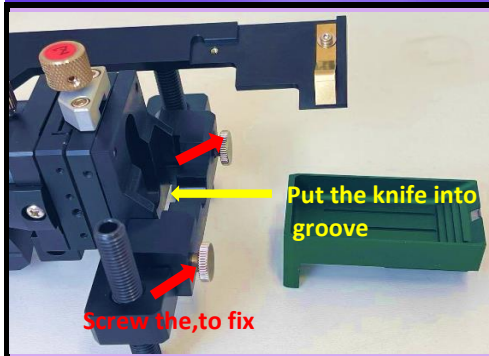

1. Loosen the screw and set the knife to CUESTA and tighten the screw to fix it.
*Check if not loose

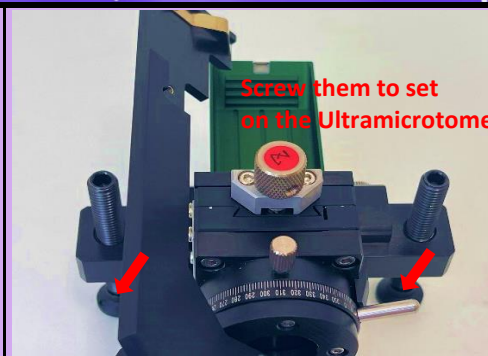

2. Put it on the Ultramicrotome and turn the screw to stabilize.
*Clearance angle is 0°

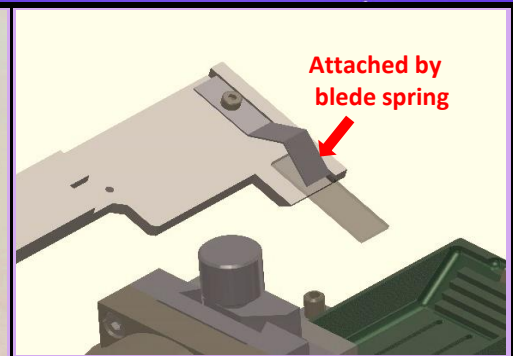

3. Set the plates (Ex. Glass, Wafer etc) to the top of the arm and fix by blade spring

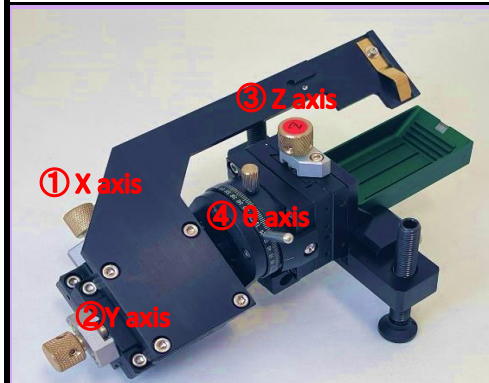

4. Adjust the arm at your preference by screwing the axes
*Adjust the arm angle by θ axis

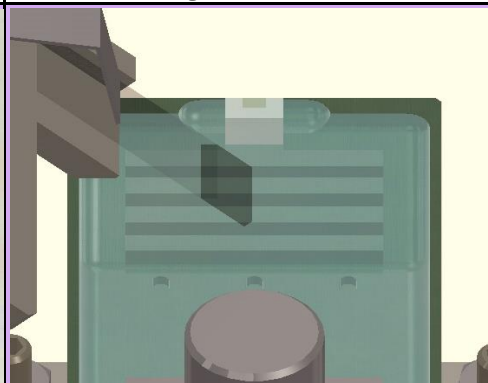

5. Pour the water and start to section
*Same cutting way as usual

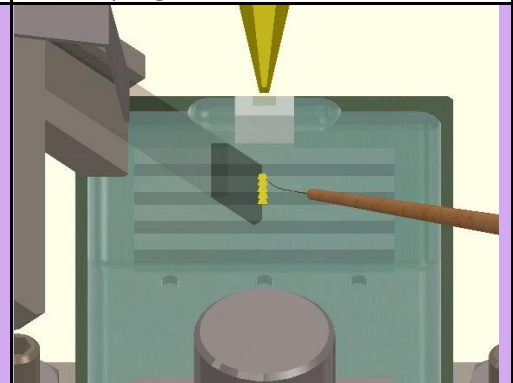

6. Guide the section to the plate by the probe when you make some sections

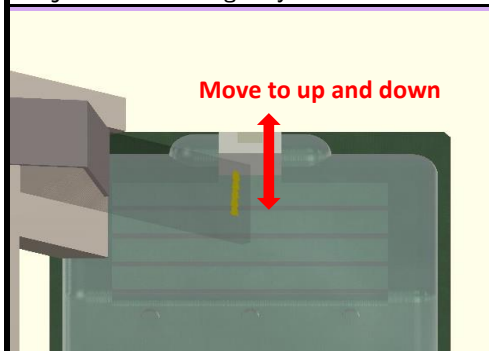

7-1. "Lift"
Move the plate up and down to collect the sections by using Z axis

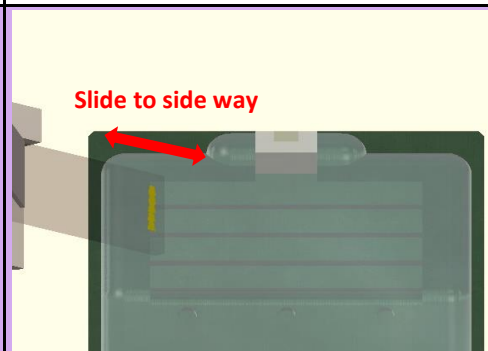

7-2. "Scoop Up"
Slide the plate to side way to collect the sections by using X axis

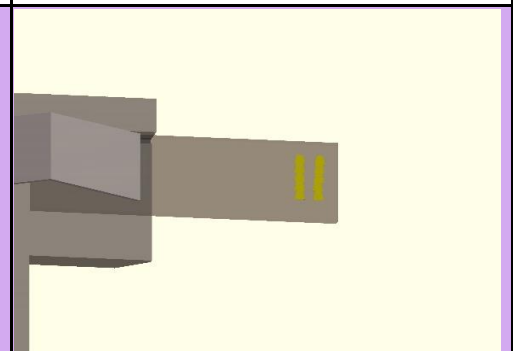

8. Collect the some serial sections by this routine work

Installable SYM Knives for SYM CUESTA

SYM JUMBO series					
Ultra Wet					
Item No.	Blade Angle	Width	Item No.	Blade Angle	Width
SYM2035J	35°	2.0mm	SYM2035WT	35°	2.0mm
SYM2045J	45°		SYM2045WT	45°	
SYM3045J	45°	3.0mm	SYM3045WT	45°	3.0mm
Histo Wet					
SYM3045HJ	45°	3.0mm	SYM3045HWT	45°	3.0mm
SYM3050HJ	50°		SYM3050HWT	50°	
SYM6045HJ	45°	6.0mm	SYM6045HWT	45°	6.0mm
SYM6050HJ	50°		SYM6050HWT	50°	

This is "The Future Standard"!



SYNTEK CO., LTD (Japan)

